

ARTY Profile 20°

Arty Profile 20° is a small and powerful profile spotlight

Fixed beam angle.

Built-in framing shutters delivers sharp edges.

On board dimmer.



Description

Arty Profile 20° is a narrow beam profile spotlight.

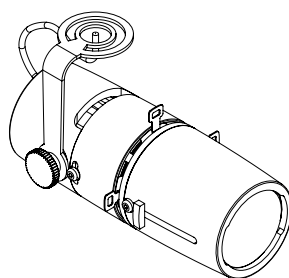
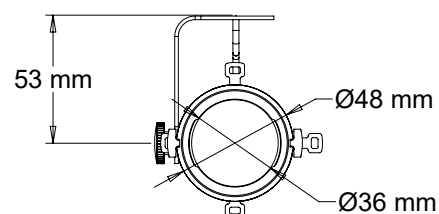
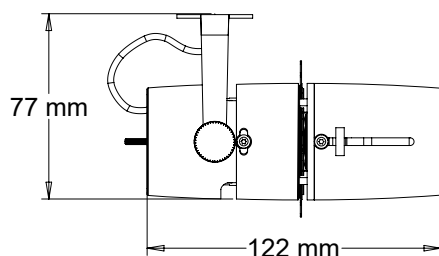

TECHNICAL SPECIFICATION

Material	Lamp housing of aluminium Yoke and details of steel Adapter of PC Anti-reflective lenses
Finish	Grey (RAL 9006) Black (RAL 9005) White (RAL 9016)
System	12V DC Mini Trac (3 phase circuit track)
Dimming control	Built-in dimmer Not compatible with mains dimmer
Protection class	IP20
Operating voltage	12V DC/230V/CC
Power consumption	8W
CRI	90
Color temperature	2700K/3000K/4000K
Beam angle	Fixed 20°
Swivels	>365°
Tilts	>90°
Optional accessories	Honeycomb 40mm

ARTY PROFILE 20° / MINI TRAC

Built in local dimmer (0-100%)

2700K	<input type="checkbox"/>	ARTP27C-MT-1	Arty Profile 20° 12V DC/8W Mini Trac 2700K, Grey	500, CRI 90, 20°, dimmer
	<input type="checkbox"/>	ARTP27C-MT-2	Arty Profile 20° 12V DC/8W Mini Trac 2700K, Black	500, CRI 90, 20°, dimmer
	<input type="checkbox"/>	ARTP27C-MT-3	Arty Profile 20° 12V DC/8W Mini Trac 2700K, White	500, CRI 90, 20°, dimmer
3000K	<input type="checkbox"/>	ARTP30C-MT-1	Arty Profile 20° 12V DC/8W Mini Trac 3000K, Grey	530, CRI 90, 20°, dimmer
	<input type="checkbox"/>	ARTP30C-MT-2	Arty Profile 20° 12V DC/8W Mini Trac 3000K, Black	530, CRI 90, 20°, dimmer
	<input type="checkbox"/>	ARTP30C-MT-3	Arty Profile 20° 12V DC/8W Mini Trac 3000K, White	530, CRI 90, 20°, dimmer
4000K	<input type="checkbox"/>	ARTP40C-MT-1	Arty Profile 20° 12V DC/8W Mini Trac 4000K, Grey	530, CRI 90, 20°, dimmer
	<input type="checkbox"/>	ARTP40C-MT-2	Arty Profile 20° 12V DC/8W Mini Trac 4000K, Black	530, CRI 90, 20°, dimmer
	<input type="checkbox"/>	ARTP40C-MT-3	Arty Profile 20° 12V DC/8W Mini Trac 4000K, White	530, CRI 90, 20°, dimmer

ARTY PROFILE 20° / SOLO

Built in local dimmer (0-100%)

2700K	<input type="checkbox"/>	ARTP27C-LVS-1	Arty Profile 20° 12V DC/8W Solo 2700K, Grey	500lm, CRI 90, 20°, dimmer, 1m cable
	<input type="checkbox"/>	ARTP27C-LVS-2	Arty Profile 20° 12V DC/8W Solo 2700K, Black	500lm, CRI 90, 20°, dimmer, 1m cable
	<input type="checkbox"/>	ARTP27C-LVS-3	Arty Profile 20° 12V DC/8W Solo 2700K, White	500lm, CRI 90, 20°, dimmer, 1m cable
3000K	<input type="checkbox"/>	ARTP30C-LVS-1	Arty Profile 20° 12V DC/8W Solo 3000K, Grey	530lm, CRI 90, 20°, dimmer, 1m cable
	<input type="checkbox"/>	ARTP30C-LVS-2	Arty Profile 20° 12V DC/8W Solo 3000K, Black	530lm, CRI 90, 20°, dimmer, 1m cable
	<input type="checkbox"/>	ARTP30C-LVS-3	Arty Profile 20° 12V DC/8W Solo 3000K, White	530lm, CRI 90, 20°, dimmer, 1m cable
4000K	<input type="checkbox"/>	ARTP40C-LVS-1	Arty Profile 20° 12V DC/8W Solo 4000K, Grey	530lm, CRI 90, 20°, dimmer, 1m cable
	<input type="checkbox"/>	ARTP40C-LVS-2	Arty Profile 20° 12V DC/8W Solo 4000K, Black	530lm, CRI 90, 20°, dimmer, 1m cable
	<input type="checkbox"/>	ARTP40C-LVS-3	Arty Profile 20° 12V DC/8W Solo 4000K, White	530lm, CRI 90, 20°, dimmer, 1m cable

ARTY PROFILE 20° / 230V

Multi-adapter for 3 phase circuit track with built-in local dimmer (0-100%)

2700K	<input type="checkbox"/>	ARTP27C-HV-1	Arty Profile 20° 230V/10W Multi 2700K, Grey	500lm, CRI 90, 20°, 3-phase, dimmer
	<input type="checkbox"/>	ARTP27C-HV-2	Arty Profile 20° 230V/10W Multi 2700K, Black	500lm, CRI 90, 20°, 3-phase, dimmer
	<input type="checkbox"/>	ARTP27C-HV-3	Arty Profile 20° 230V/10W Multi 2700K, White	500lm, CRI 90, 20°, 3-phase, dimmer
3000K	<input type="checkbox"/>	ARTP30C-HV-1	Arty Profile 20° 230V/10W Multi 3000K, Grey	530lm, CRI 90, 20°, 3-phase, dimmer
	<input type="checkbox"/>	ARTP30C-HV-2	Arty Profile 20° 230V/10W Multi 3000K, Black	530lm, CRI 90, 20°, 3-phase, dimmer
	<input type="checkbox"/>	ARTP30C-HV-3	Arty Profile 20° 230V/10W Multi 3000K, White	530lm, CRI 90, 20°, 3-phase, dimmer
4000K	<input type="checkbox"/>	ARTP40C-HV-1	Arty Profile 20° 230V/10W Multi 4000K, Grey	530lm, CRI 90, 20°, 3-phase, dimmer
	<input type="checkbox"/>	ARTP40C-HV-2	Arty Profile 20° 230V/10W Multi 4000K, Black	530lm, CRI 90, 20°, 3-phase, dimmer
	<input type="checkbox"/>	ARTP40C-HV-3	Arty Profile 20° 230V/10W Multi 4000K, White	530lm, CRI 90, 20°, 3-phase, dimmer

ARTY PROFILE CC 450LM

Without driver. For single use or Installation on LED profile High or Low. Max 500mA, 6W.

2700K	<input type="checkbox"/>	ARTP27B-CCL-1	Arty Profile 20° CC/500mA LED profile 2700K, Grey	450lm, Vf=12V, 500mA, CRI90, 20°
	<input type="checkbox"/>	ARTP27B-CCL-2	Arty Profile 20° CC/500mA LED profile 2700K, Black	450lm, Vf=12V, 500mA, CRI90, 20°
	<input type="checkbox"/>	ARTP27B-CCL-3	Arty Profile 20° CC/500mA LED profile 2700K, White	450lm, Vf=12V, 500mA, CRI90, 20°
3000K	<input type="checkbox"/>	ARTP30B-CCL-1	Arty Profile 20° CC/500mA LED profile 3000K, Grey	480lm, Vf=12V, 500mA, CRI90, 20°
	<input type="checkbox"/>	ARTP30B-CCL-2	Arty Profile 20° CC/500mA LED profile 3000K, Black	480lm, Vf=12V, 500mA, CRI90, 20°
	<input type="checkbox"/>	ARTP30B-CCL-3	Arty Profile 20° CC/500mA LED profile 3000K, White	480lm, Vf=12V, 500mA, CRI90, 20°
2700K	<input type="checkbox"/>	ARTP27B-CCS-1	Arty Profile 20° CC/500mA Solo 2700K, Grey	450lm, Vf=12V, 500mA, CRI90, 20°, 1m cable
	<input type="checkbox"/>	ARTP27B-CCS-2	Arty Profile 20° CC/500mA Solo 2700K, Black	450lm, Vf=12V, 500mA, CRI90, 20°, 1m cable
	<input type="checkbox"/>	ARTP27B-CCS-3	Arty Profile 20° CC/500mA Solo 2700K, White	450lm, Vf=12V, 500mA, CRI90, 20°, 1m cable
3000K	<input type="checkbox"/>	ARTP30B-CCS-1	Arty Profile 20° CC/500mA Solo 3000K, Grey	480lm, Vf=12V, 500mA, CRI90, 20°, 1m cable
	<input type="checkbox"/>	ARTP30B-CCS-2	Arty Profile 20° CC/500mA Solo 3000K, Black	480lm, Vf=12V, 500mA, CRI90, 20°, 1m cable
	<input type="checkbox"/>	ARTP30B-CCS-3	Arty Profile 20° CC/500mA Solo 3000K, White	480lm, Vf=12V, 500mA, CRI90, 20°, 1m cable