

gimmick

Gimmick has a minimal design and is well-suited for display case lighting

Description

With Gimmick, you can get really close to objects without taking the focus from them. Subtle when mounted on pipe, e.g. in the bottom of a display case.



TECHNICAL SPECIFICATION

Material	Machined aluminum Lens of PC
Finish	Anodized Black
System	Pico Trac LED profile High/Low Pipe mounting
Dimming control	Built-in dimmer or via external dimmer
Protection class	IP20
Power consumption	Up to 2W
CRI	90
Color temperature	2700K/3000K/4000K
Beam angle	Narrow Medium Wide (standard) Very Wide
Optional accessories	Snoots

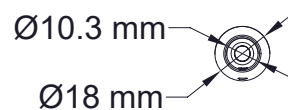
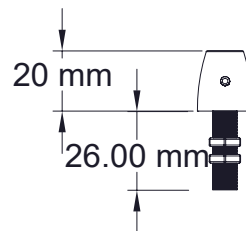
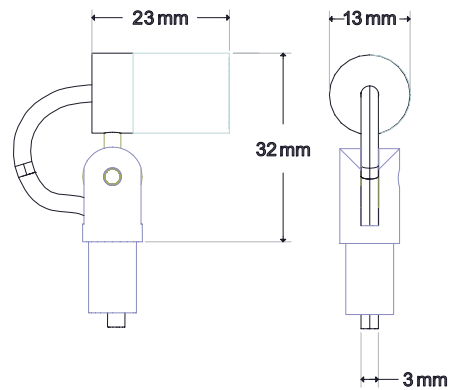

GIMMICK / PICO TRAC

Built in local dimmer

2700K		GIM27-PT-1	Gimmick 12V DC/2W Pico Trac 2700K, Grey	100lm, CRI 90, lens W, dimmer
		GIM27-PT-2	Gimmick 12V DC/2W Pico Trac 2700K, Black	100lm, CRI 90, lens W, dimmer
3000K		GIM30-PT-1	Gimmick 12V DC/2W Pico Trac 3000K, Grey	110lm, CRI 90, lens W, dimmer
		GIM30-PT-2	Gimmick 12V DC/2W Pico Trac 3000K, Black	110lm, CRI 90, lens W, dimmer
4000K		GIM40-PT-1	Gimmick 12V DC/2W Pico Trac 4000K, Grey	110lm, CRI 90, lens W, dimmer
		GIM40-PT-2	Gimmick 12V DC/2W Pico Trac 4000K, Black	110lm, CRI 90, lens W, dimmer







GIMMICK CC 100LM LED PROFILE

Installation on LED profile High or Low. Max 350mA.

2700K		GIM27-CCL-1	Gimmick CC/350mA LED Profile 2700K, Grey	90lm, Vf=3V, CRI 90, lens W
		GIM27-CCL-2	Gimmick CC/350mA LED Profile 2700K, Black	90lm, Vf=3V, CRI 90, lens W
3000K		GIM30-CCL-1	Gimmick CC/350mA LED Profile 3000K, Grey	100lm, Vf=3V, CRI 90, lens W
		GIM30-CCL-2	Gimmick CC/350mA LED Profile 3000K, Black	100lm, Vf=3V, CRI 90, lens W
4000K		GIM40-CCL-1	Gimmick CC/350mA LED Profile 4000K, Grey	100lm, Vf=3V, CRI 90, lens W
		GIM40-CCL-2	Gimmick CC/350mA LED Profile 4000K, Black	100lm, Vf=3V, CRI 90, lens W





GIMMICK CC 100LM PIPE MOUNTING

Installation on 10mm Pipe. Max 350mA.

2700K		GIM27-CCR-1	Gimmick CC/350mA Rod 2700K, Grey	90lm, Vf=3V, CRI 90, lens W, 1.5m cable
		GIM27-CCR-2	Gimmick CC/350mA Rod 2700K, Black	90lm, Vf=3V, CRI 90, lens W, 1.5m cable
3000K		GIM30-CCR-1	Gimmick CC/350mA Rod 3000K, Grey	100lm, Vf=3V, CRI 90, lens W, 1.5m cable
		GIM30-CCR-2	Gimmick CC/350mA Rod 3000K, Black	100lm, Vf=3V, CRI 90, lens W, 1.5m cable
4000K		GIM40-CCR-1	Gimmick CC/350mA Rod 4000K, Grey	100lm, Vf=3V, CRI 90, lens W, 1.5m cable
		GIM40-CCR-2	Gimmick CC/350mA Rod 4000K, Black	100lm, Vf=3V, CRI 90, lens W, 1.5m cable

GIMMICK PIPE ACCESSORIES

To get a complete unit, you need 1 fixture, 1 foot, 1 rod

	GIM-RF-1	Mounting foot, Grey	For 10mm rod, M8
	GIM-RF-2	Mounting foot, Black	For 10mm rod, M8
	GIM-R-1	Rod 50–650mm, Grey	Ø10mm rod
	GIM-R-2	Rod 50–650mm, Black	Ø10mm rod